

BOTHAR NA dTREABH MULTI-MODAL CORRIDOR IMPROVEMENT SCHEME - HEADFORD ROAD (N6)

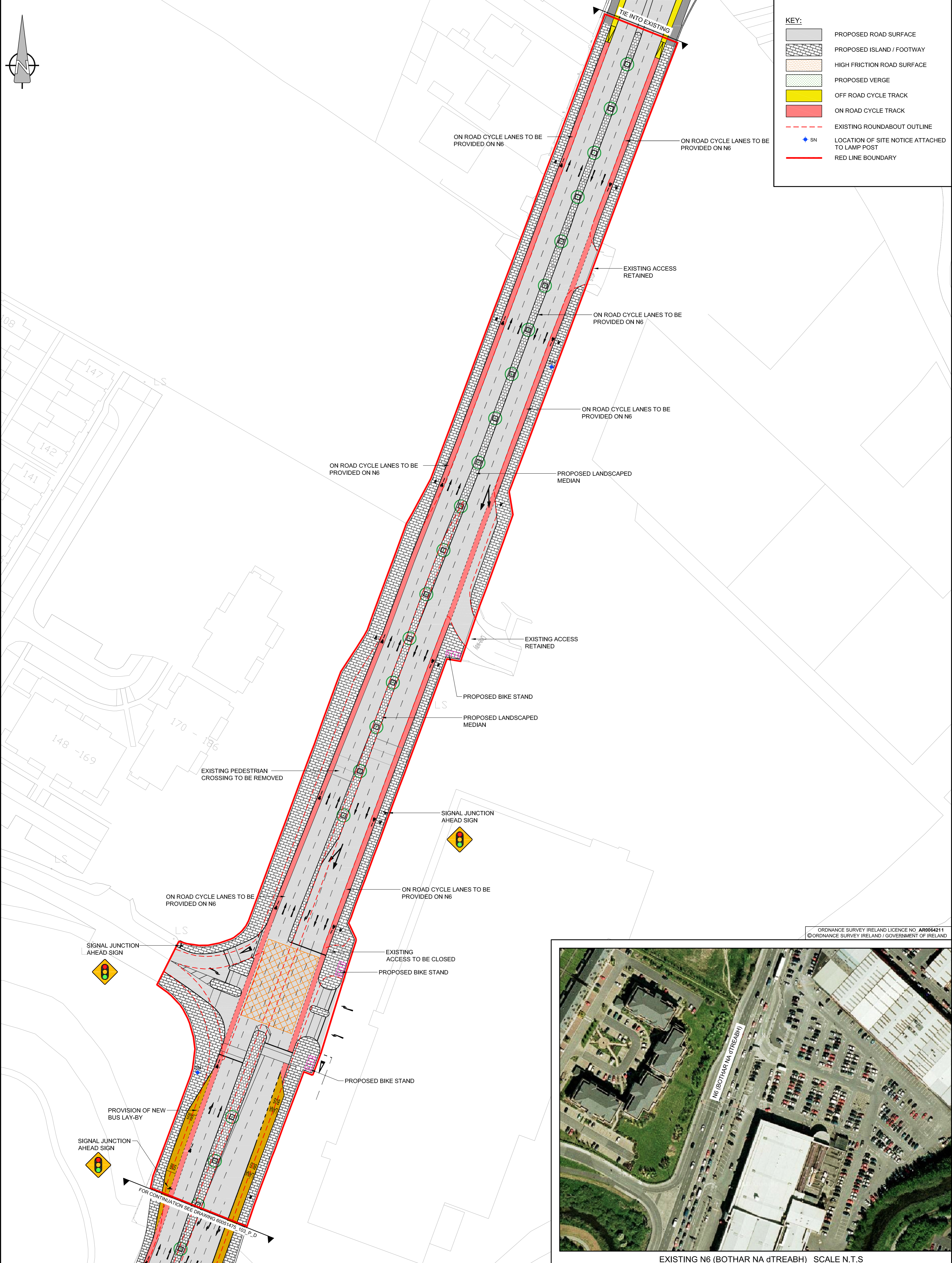

KEY:

- PROPOSED ROAD SURFACE
- PROPOSED ISLAND / FOOTWAY
- HIGH FRICTION ROAD SURFACE
- PROPOSED VERGE
- OFF ROAD CYCLE TRACK
- ON ROAD CYCLE TRACK
- EXISTING ROUNDABOUT OUTLINE
- SN
- LOCATION OF SITE NOTICE ATTACHED TO LAMP POST
- RED LINE BOUNDARY



ORDNANCE SURVEY IRELAND LICENCE NO. AR0064211
©ORDNANCE SURVEY IRELAND / GOVERNMENT OF IRELAND

Rev	Date	Detail	Made	Chkd	App'd
B	28.10.11	LAYOUT REVISED	RH	EOM	JS
A	12.04.11	PRELIMINARY ISSUE	RH	EOM	JS

Status: **PUBLIC CONSULTATION**

NOTES:

ALL PEDESTRIAN CROSSING POINTS TO BE CONSTRUCTED IN ACCORDANCE WITH NATIONAL DISABILITY AUTHORITY GUIDELINES (TACTILE PAVING, DROPPED KERBS, ETC.).

OS TILE No.062026-OS-3345-23, No.062026-OS-3345-24

Client:

Project: **BOTHAR NA dTREABH MULTI-MODAL CORRIDOR IMPROVEMENT SCHEME**

Design: RK Date: OCTOBER 2011 Chk'd: EOM
 Drawn: RH Scale: 1:500 App'd: JS

Roughan & O'Donovan **AECOM**

Ground Floor, Grand Canal House, Upper Grand Canal Street, Dublin 4.

Tel: +353 (0) 1 238 3100 Fax: +353 (0) 1 238 3199 www.aecom.com

Title: **PROPOSED LAYOUT OF HEADFORD ROAD (N6)**

Project No.	Dwg No.	Stat.	Rev.
60051475	104	PC	B