

# St. Mary's Cast Iron DMA

## Section 1 – Palmyra Park TM Overview

- Farrans have been contracted by Irish Water to carry out mains rehabilitation throughout the North and Northwest Regions of Ireland. One of the areas highlighted for mains rehabilitation is St Mary's Road DMA, Galway City, Section 1 of this scheme is Palmyra Park.
- In order to complete the mains installation works in Palmyra Park, it is necessary to close this street, as the road is only 3-4m wide in places.
- Palmyra Park Closure (L-5117-0).
- Diversion route via R-337-4, R-864-16 & L-5109-0
- The following plans show the areas where works will be taking place and where the Traffic management systems will be used.
- All traffic management signage will be accordance with Chapter 8. Signs such as 'Men at Work' and advance warning distance markers are not shown on these plans for clarity but will be in place during the works.
- Access for emergency vehicles to be accommodated at all times.
- Access for businesses and Local residents will be maintained, but may be limited by agreement to certain times
- Entire St. Marys Road DMA Scheme layout is shown on slide 2, we are only concerned about Palmyra Park in the Closure Application (Highlighted Green).
- Diversion routes are shown on slide 3.
- Diversion routes signing is on slide 4.

### NOTES

1. All signs will comply with Traffic Sign Regulations.
2. All Traffic Management to be in accordance with Chapter 8.

**FARRANS**

#### UTILITIES

Farrans Construction Ltd  
99 Kingsway,  
Dunmurry,  
BT17 9NU.

#### Project:

Irish Water Network  
Management  
St Mary's Road DMA,  
Galway City

# St Mary's Road DMA - TM Overview

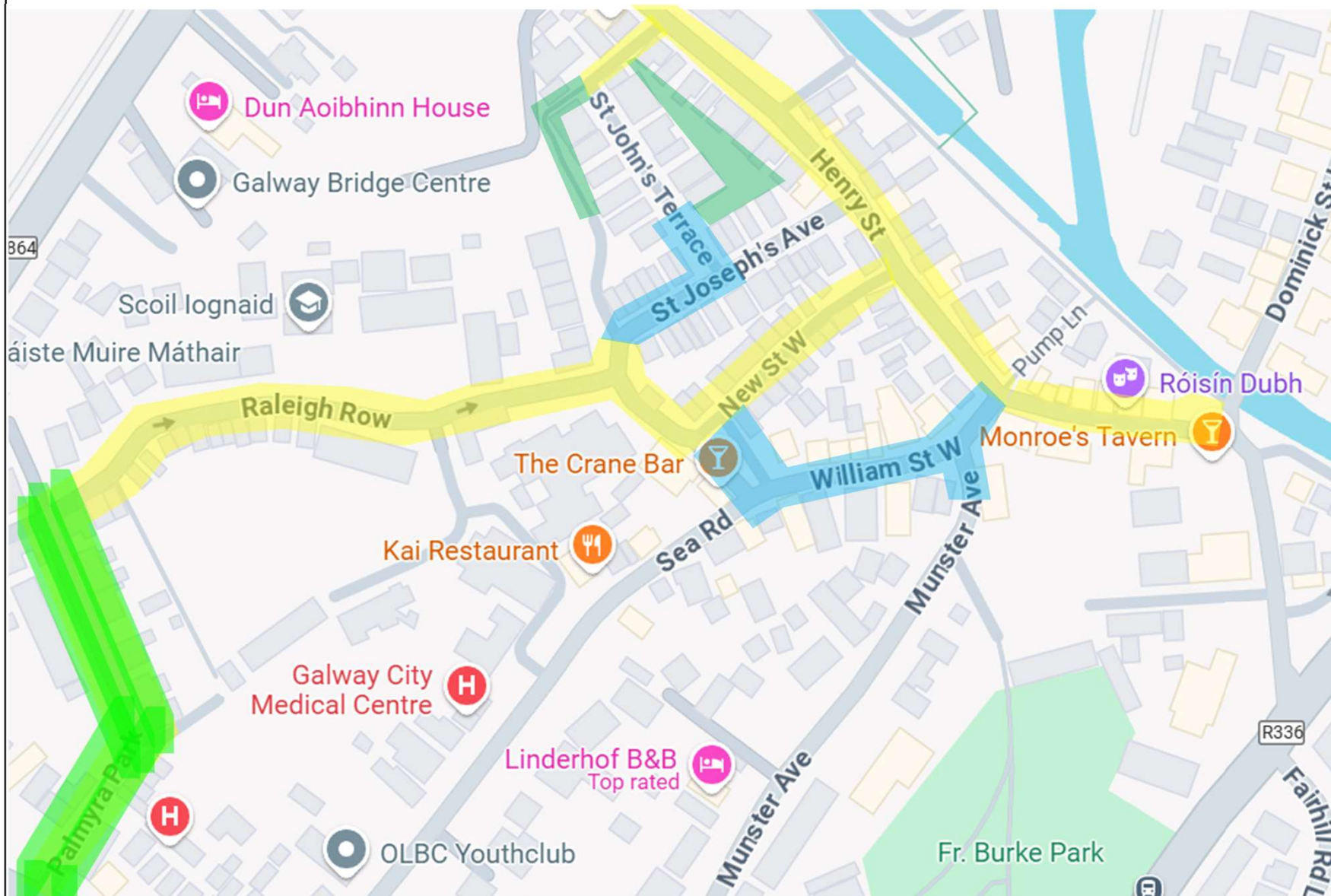

## NOTES

1. All signs will comply with Traffic Sign Regulations.
2. All Traffic Management to be in accordance with Chapter 8.

**FARRANS**

## UTILITIES

Farrans Construction Ltd  
99 Kingsway,  
Dunmurry,  
BT17 9NU.

## Project:

Irish Water Network  
Management  
St Mary's Road  
DMA, Galway City



# St. Mary's Cast Iron DMA

## Section 1 – Palmyra Park Diversion Route

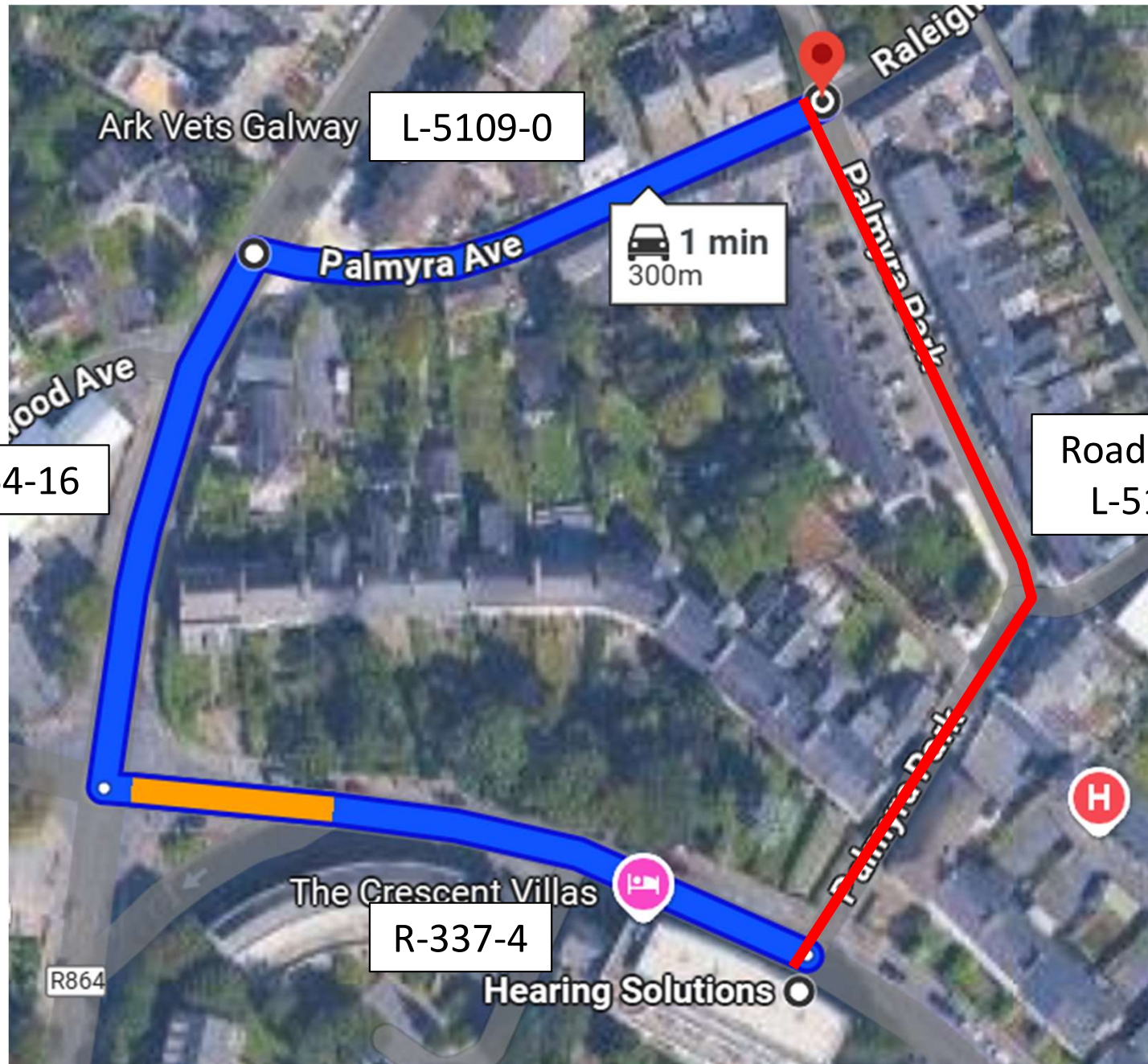

### NOTES

1. All signs will comply with Traffic Sign Regulations.
2. All Traffic Management to be in accordance with Chapter 8.

**FARRANS**

### UTILITIES

Farrans Construction Ltd  
99 Kingsway,  
Dunmurry,  
BT17 9NU.

### Project:

Irish Water Network  
Management  
St Mary's Road  
DMA, Galway City

# St. Mary's Cast Iron DMA

## Section 1 – Palmyra Park TM Overview

Signage for road closure and diversion as below.

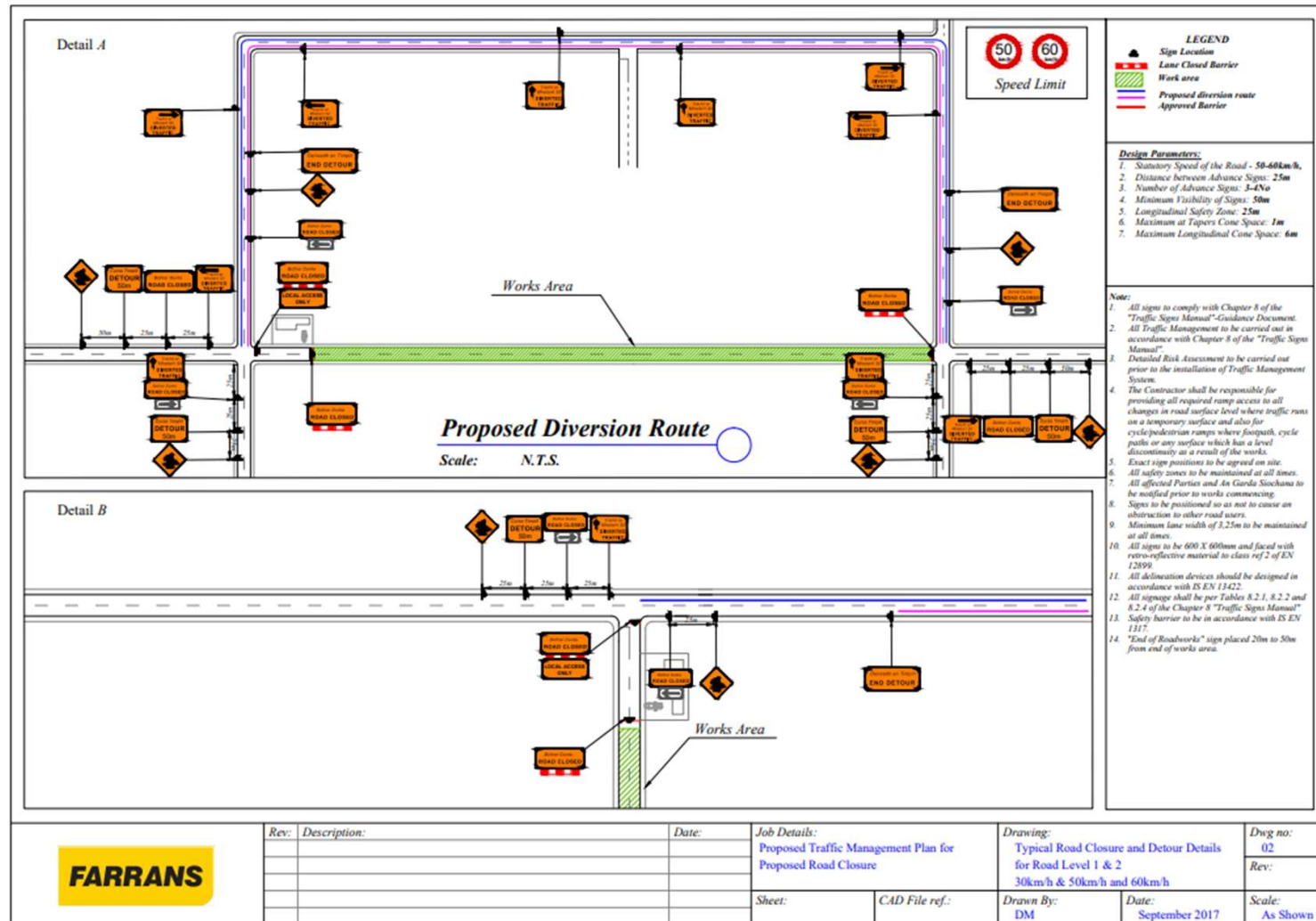

### NOTES

1. All signs will comply with Traffic Sign Regulations.
2. All Traffic Management to be in accordance with Chapter 8.

**FARRANS**

### UTILITIES

Farrans Construction Ltd  
99 Kingsway,  
Dunmurry,  
BT17 9NU.

### Project:

Irish Water Network  
Management  
West Port Ballyshannon